

Date	Revision
04.12.25	2



Installation Instructions: Skyline Powertron Codes: 91827, 91828, 91829, 91830, 11330V2, 11331V2, 11332V2

**Read these instructions before installation and retain for future reference.
This equipment should be installed by a competent electrician**

Important Information

We recommend that luminaires are installed by a qualified electrician ensuring the installation complies with current IEE wiring regulations BS7671:2018 & local building controll.

- BELL will not accept responsibility for any claims arising from a poor installation.
- Always switch off mains supply before installing.
- All tests should be carried out in accordance to EN 50172:2004

This product may contain substances that can be hazardous to the environment if not disposed of properly. Electrical and electronic equipment should never be disposed of with general household waste but must be separated for its correct treatment and recovery. Where possible recycle your packaging.

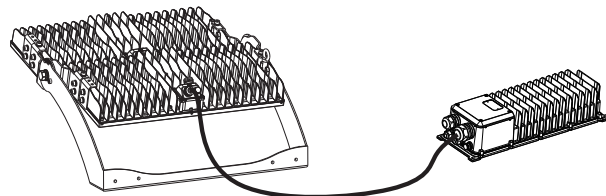
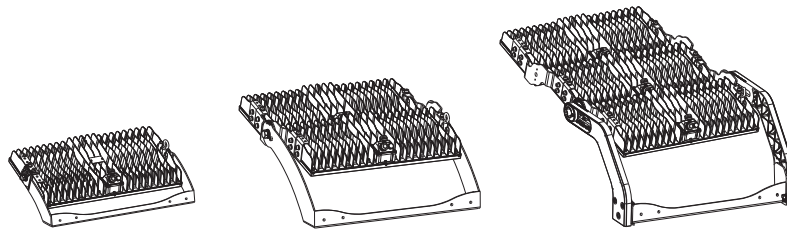
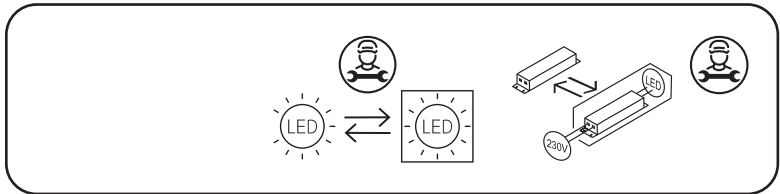

L ≤ 50M CABLE NOT SUPPLIED

If the driver box needs to be installed at a distance surpassing 50 meters from the lamp, please kindly consult our sales for a solution.

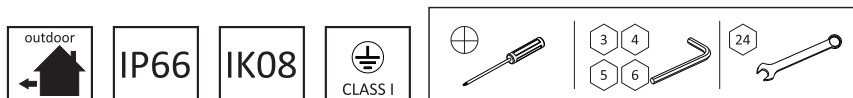

Helpline +44 (0)1924 893380
www.bellighting.co.uk

British Electric Lamps Ltd
BELL House, Foxbridge Way, Normanton Industrial Estate
Normanton, West Yorkshire. WF6 1TN

T: +44 (0)1924 893380 F: +44 (0)1924 894320
E: sales@bellighting.co.uk

www.bellighting.co.uk

Date	Revision
04.12.25	2



Installation Instructions: Skyline Powertron Codes: 91827, 91828, 91829, 91830, 11330V2, 11331V2, 11332V2

**READ AND FOLLOW ALL SAFETY INSTRUCTIONS.
SAVE THE MANUAL FOR FUTURE REFERENCE!**

⚠ WARNING

To avoid electric shock:

- Installation and wiring of luminaire must be in accordance with all applicable local codes.
- Installation, inspection, and maintenance of luminaires should be performed by a qualified electrician.
- DO NOT** make or alter any open holes in the luminaire.
- DO NOT** modify the luminaire.
- DO NOT** install damaged product.
- Make sure electrical power is OFF before and during installation and maintenance.
- Make sure the equipment is properly grounded.
- Make sure the supply voltage is same as the rated fixture voltage.

To perform maintenance:

- Only use luminaire in its intended location.
- Make sure the luminaire is not covered with material that will prevent convection or conduction cooling.
- It's suggested to perform visual, electrical, and mechanical inspections on a regular basis and cleaned with a non-aggressive product.
- Any deterioration in the cables should be noted and reported to a suitably qualified electrician who will advise an appropriate course of action.
- The Surge Protective Device (SPD) will need replacing when it comes to the end of its useful life. This should be checked for operation during the annual maintenance.

POSITIONS ALLOWED

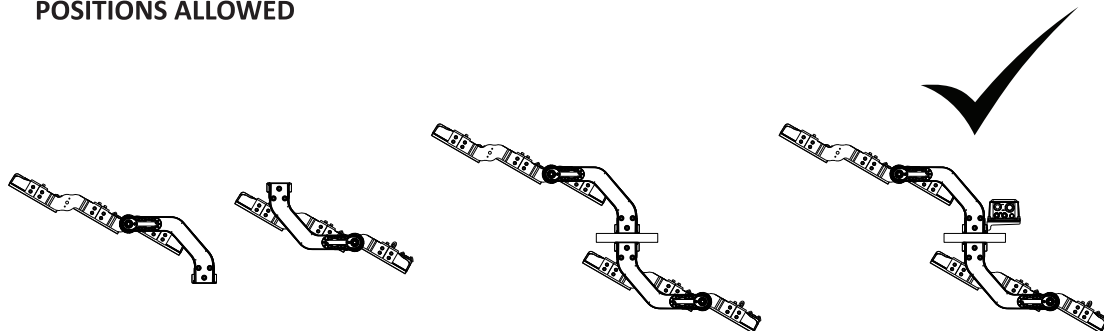

POSITIONS NOT ALLOWED

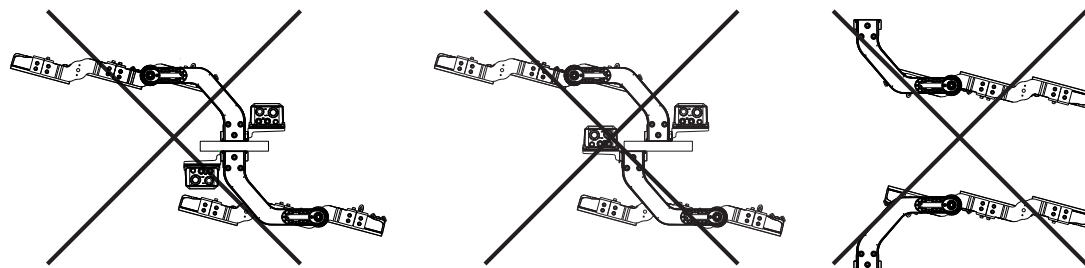

British Electric Lamps Ltd
BELL House, Foxbridge Way, Normanton Industrial Estate
Normanton, West Yorkshire. WF6 1TN

T: +44 (0)1924 893380 F: +44 (0)1924 894320
E: sales@belllighting.co.uk

Helpline +44 (0)1924 893380
www.belllighting.co.uk

www.belllighting.co.uk



Installation Instructions: Skyline Powertron Codes: 91827, 91828, 91829, 91830, 11330V2, 11331V2, 11332V2

LUMINAIRE (Unit: mm)

600W

kg
8.5KG

1200W

kg
21.7KG

1800W

kg
31KG

Luminaire Windage Area(SCx)

Power	SCX0°*	SCX15°*	SCX30°*	SCX45°*	SCX60°*	SCX75°*
600W	0.08m ²	0.12m ²	0.15m ²	0.17m ²	0.18m ²	0.18m ²
1200W	0.10m ²	0.20m ²	0.27m ²	0.33m ²	0.37m ²	0.39m ²
1800W	0.12m ²	0.26m ²	0.39m ²	0.49m ²	0.56m ²	0.59m ²

Luminaire Windage Area(SCx) with visor SP02-L85

Power	SCX0°*	SCX15°*	SCX30°*	SCX45°*	SCX60°*	SCX75°*
600W	0.09m ²	0.13m ²	0.16m ²	0.18m ²	0.20m ²	0.23m ²
1200W	0.11m ²	0.20m ²	0.29m ²	0.35m ²	0.40m ²	0.45m ²
1800W	0.13m ²	0.28m ²	0.41m ²	0.52m ²	0.61m ²	0.66m ²

British Electric Lamps Ltd
 BELL House, Foxbridge Way, Normanton Industrial Estate
 Normanton, West Yorkshire. WF6 1TN



Installation Instructions: Skyline Powertron Codes: 91827, 91828, 91829, 91830, 11330V2, 11331V2, 11332V2

Luminaire Windage Area(SCx) with visor SP02-L186

Power	SCX0°*	SCX15°*	SCX30°*	SCX45°*	SCX60°*	SCX75°*
600W	0.16m ²	0.13m ²	0.17m ²	0.19m ²	0.24m ²	0.29m ²
1200W	0.17m ²	0.22m ²	0.30m ²	0.37m ²	0.45m ²	0.52m ²
1800W	0.19m ²	0.29m ²	0.43m ²	0.54m ²	0.66m ²	0.75m ²

* These data refer to the worst case at indicated angle

DRIVER BOX (Unit: mm)

AHF-1K2SP-400DD
1200W
4.5KG

SLK-600-C Series 600W
4.0KG

AHF-1K8SP-400DD 1800W
6.0KG

Driver Model	Luminaire Wattage	MCB Type	Input Voltage	Quantity
SLK-600-C Series	600W	MCB 16A B Type	AC 200-480	3
		MCB 32A B Type	AC 200-480	6
		MCB 16A C Type	AC 200-480	3
		MCB 32A C Type	AC 200-480	7
AHF-1K2SP-400DD	1200W	MCB 16A B Type	AC 200-480	2
		MCB 32A B Type	AC 200-480	4
		MCB 16A C Type	AC 200-480	2
		MCB 32A C Type	AC 200-480	4
AHF-1K8SP-400DD	1800W	MCB 16A B Type	AC 200-480	1
		MCB 32A B Type	AC 200-480	3
		MCB 16A C Type	AC 200-480	1
		MCB 32A C Type	AC 200-480	3

OVERSLUNG INSTALLATION

* Reference dimension drawing

! 1xM20 with extra large washer(not provided)

! 2xM20 with extra large washer(not provided)

! In case of using only one fixation point and if the luminaire is higher >3m, the use of a 2nd fixing security system is needed.

600W:

- 4 Torx screws (8N.m)
- 18mm Allen key (29N.m)

1200W:

- 4 Torx screws (8N.m)
- 24mm Allen key (114N.m)

1800W:

- 4 Torx screws (8N.m)
- 14mm Allen key (114N.m)

Don't pull out the bolt when you rotate the luminaire

Rotatable angle

600W/1200W: 25°

1800W: 55°



Installation Instructions: Skyline Powertron Codes: 91827, 91828, 91829, 91830, 11330V2, 11331V2, 11332V2

UNDERSLUNG INSTALLATION

600W:
 8N.m
 29N.m

1200W:
 8N.m
 114N.m

1800W:
 8N.m
 114N.m

Don't pull out the bolt when you rotate the luminaire

Rotate the bracket as shown below

Rotatable angle

600W/1200W

1800W



Installation Instructions: Skyline Powertron Codes: 91827, 91828, 91829, 91830, 11330V2, 11331V2, 11332V2

REMOTE DRIVER BOXES INSTALLATION

A. Installation of driver boxes on surface

Drilling recommendation

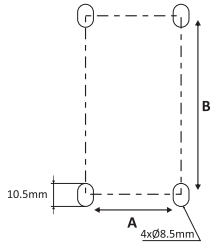

Driver Model	SLK-600-C Series	AHF-1K2SP-400DD	AHF-1K8SP-400DD
Distance A	195mm	137.6mm	137.6mm
Distance B	530mm	400mm	468mm
Screws (not provided)	4xM6	4xM6	4xM6

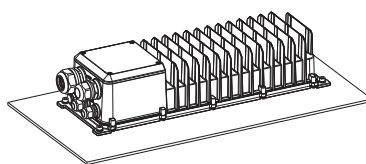
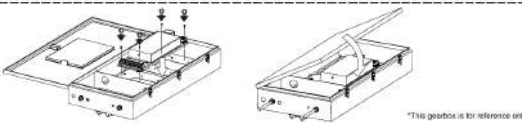
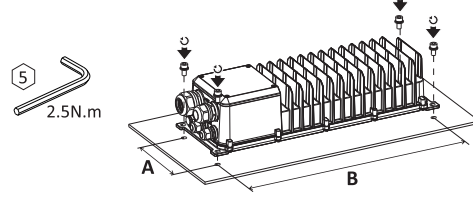
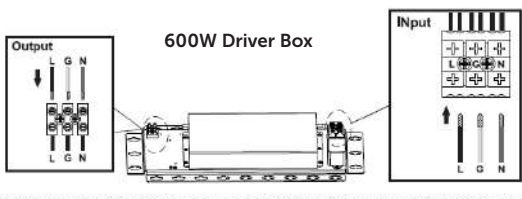

B. Installation of driver boxes on pole (optional)

- ① M6 4PCS 2.5 N.m
- ② 2PCS

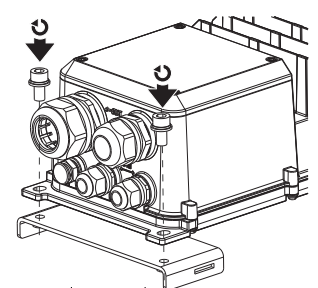

Clamp Mounting Bracket (11821)

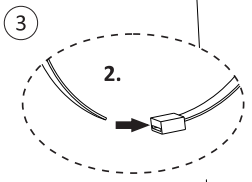
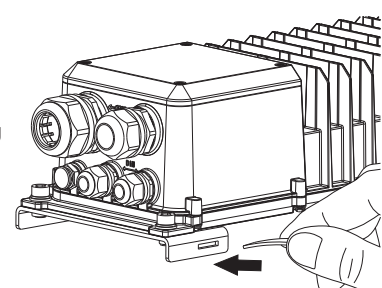

Size: 0130~300mm

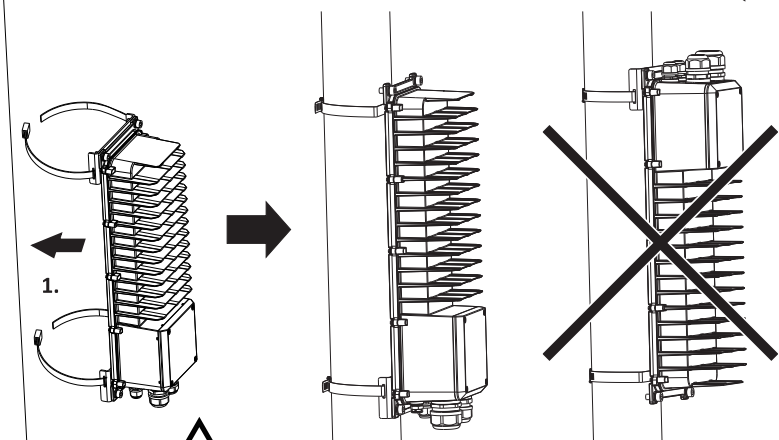

Cable glands oriented toward the ground.



Installation Instructions: Skyline Powertron Codes: 91827, 91828, 91829, 91830, 11330V2, 11331V2, 11332V2

C. Installation of driver boxes in cabinet

Each driver box in the cabinet has to be in vertical position.

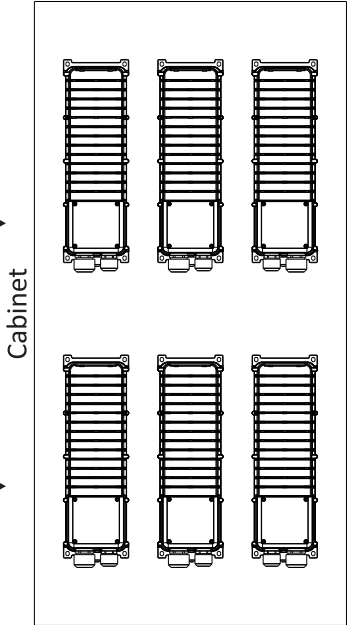

It is highly recommended to select a painted cabinet enclosure with high reflectance ratio to protect from solar radiant energy.



An active cooling can be added in the cabinet to guarantee a maximum temperature of 45°C all along the year.

The distances between driver boxes or wall have to be higher than:

ITEM	DISTANCE
A	Min 80 mm
B	Min 80 mm
C	Min 120 mm
D	Min 150 mm

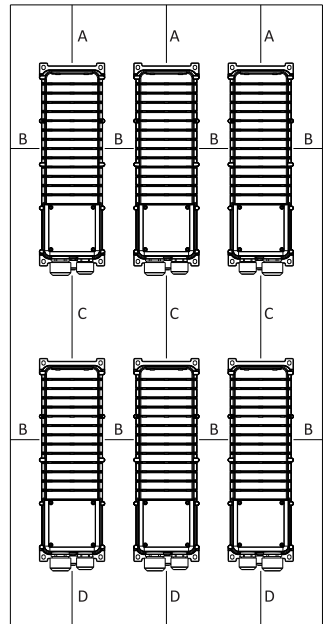

If you cannot follow the instructions, a thermal study must be done in order to respect Tc of the drivers below Tc max, Tc of the driver must be checked.

Date	Revision
04.12.25	2



Installation Instructions: Skyline Powertron Codes: 91827, 91828, 91829, 91830, 11330V2, 11331V2, 11332V2

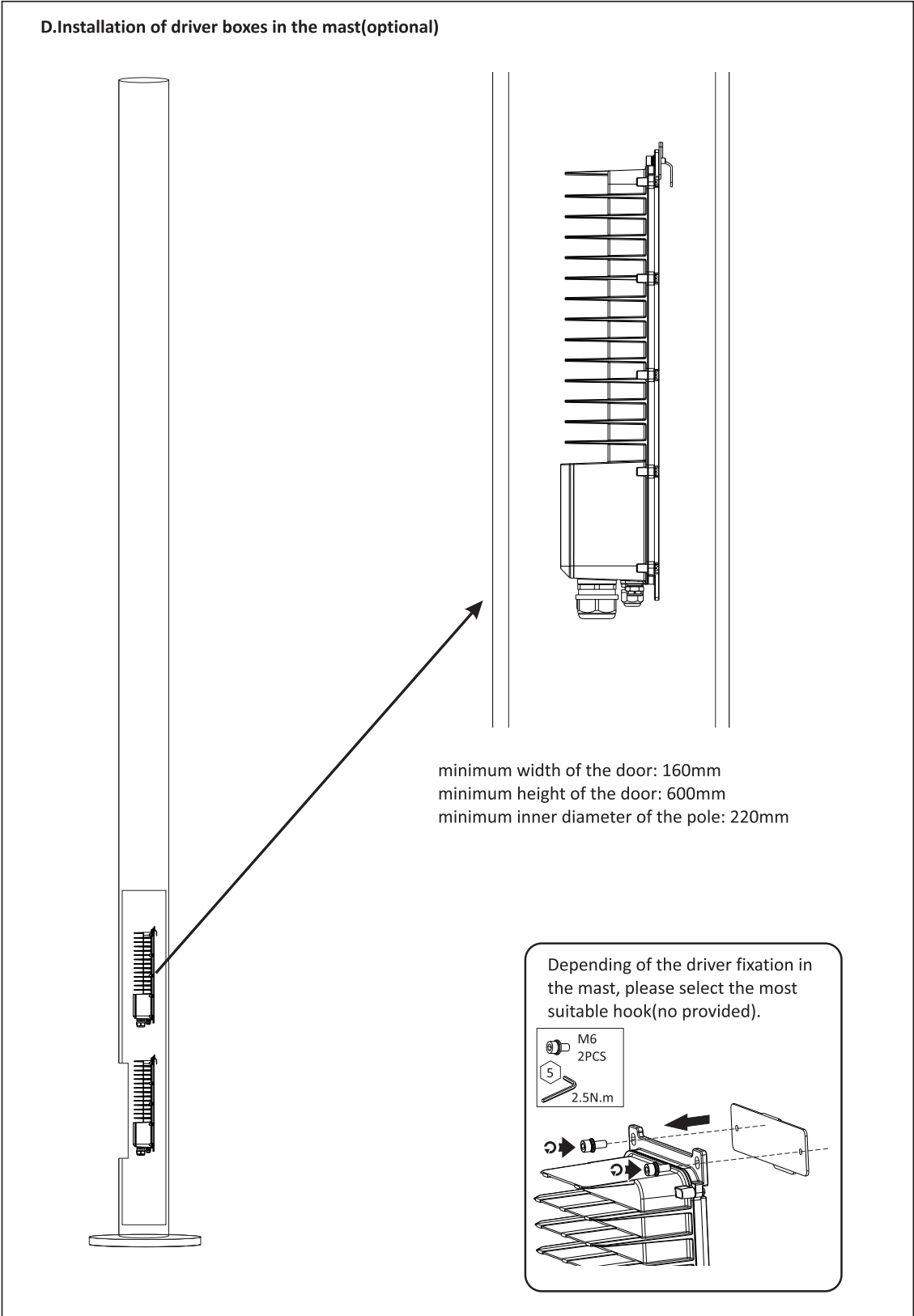



Installation Instructions: Skyline Powertron Codes: 91827, 91828, 91829, 91830, 11330V2, 11331V2, 11332V2

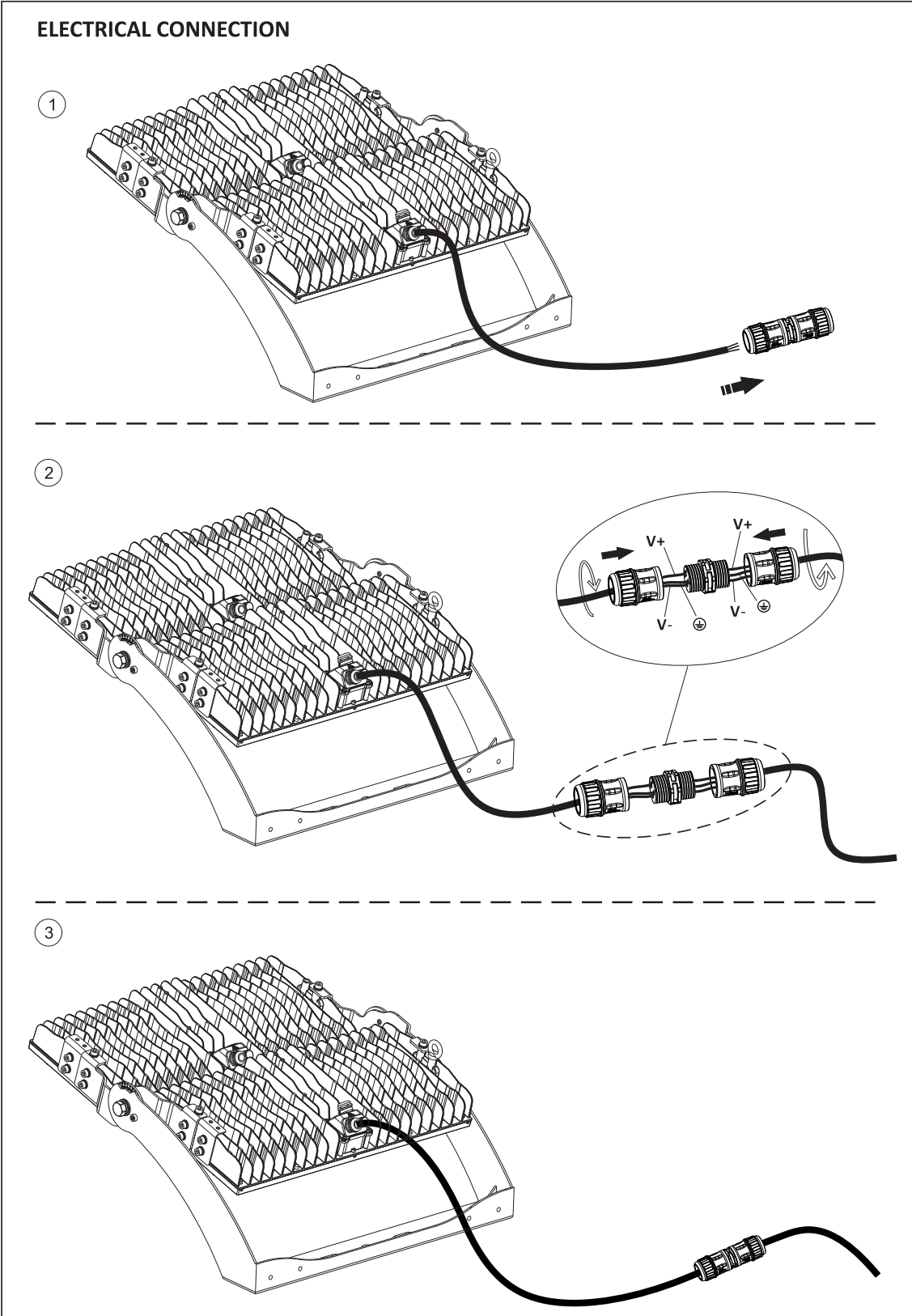

British Electric Lamps Ltd
 BELL House, Foxbridge Way, Normanton Industrial Estate
 Normanton, West Yorkshire. WF6 1TN

T: +44 (0)1924 893380 F: +44 (0)1924 894320
 E: sales@belllighting.co.uk



Installation Instructions: Skyline Powertron Codes: 91827, 91828, 91829, 91830, 11330V2, 11331V2, 11332V2

INSTALLATION OF DRIVER BOXES ON THE LUMINAIRE

M8
2PCS
8 N.m

Stirrup Mounting Bracket (11820)

M6
4PCS
2.5 N.m

! The driver box cannot be upside down.

Wiring driver box

600W Wiring



Installation Instructions: Skyline Powertron Codes: 91827, 91828, 91829, 91830, 11330V2, 11331V2, 11332V2

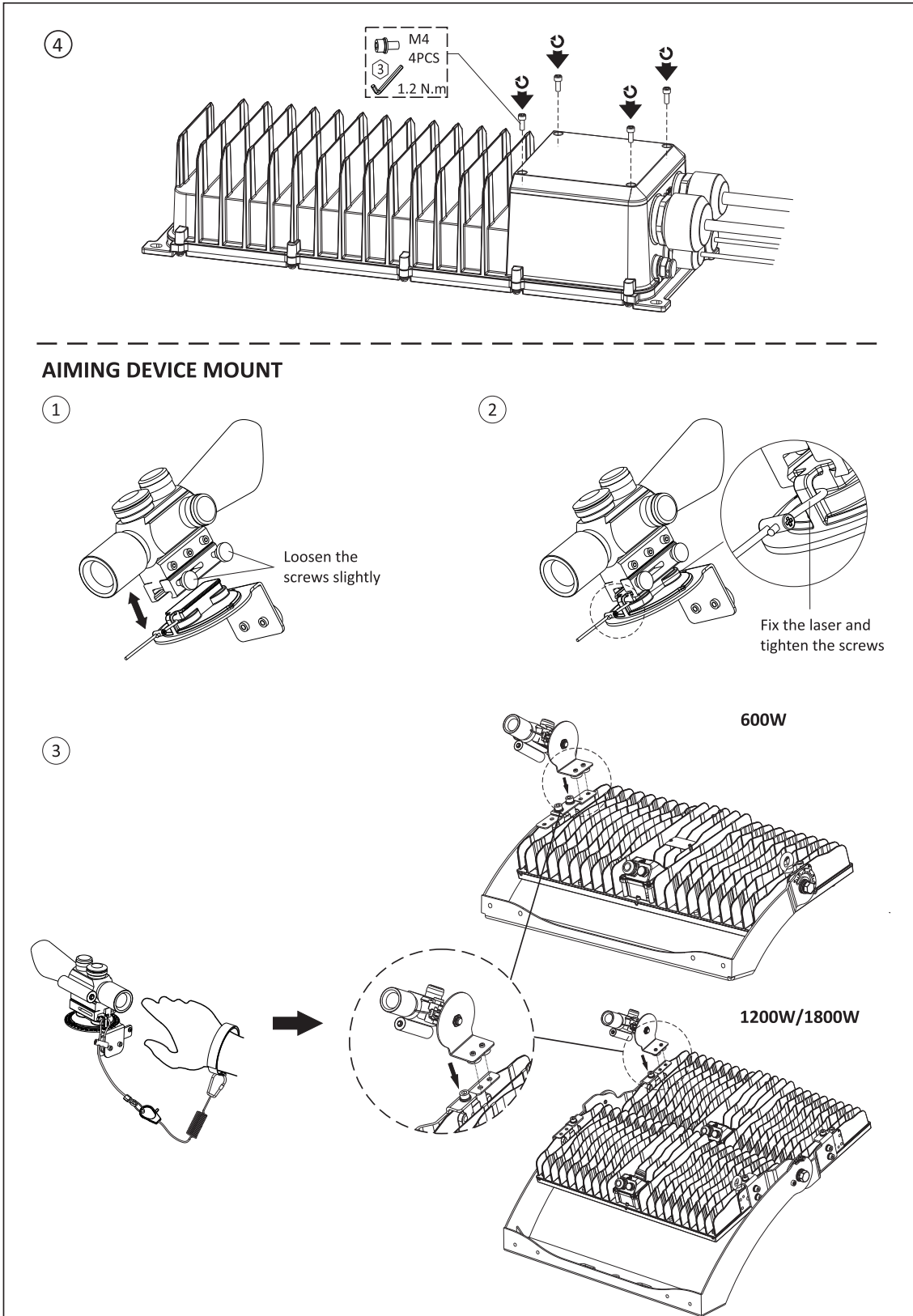



Installation Instructions: Skyline Powertron Codes: 91827, 91828, 91829, 91830, 11330V2, 11331V2, 11332V2

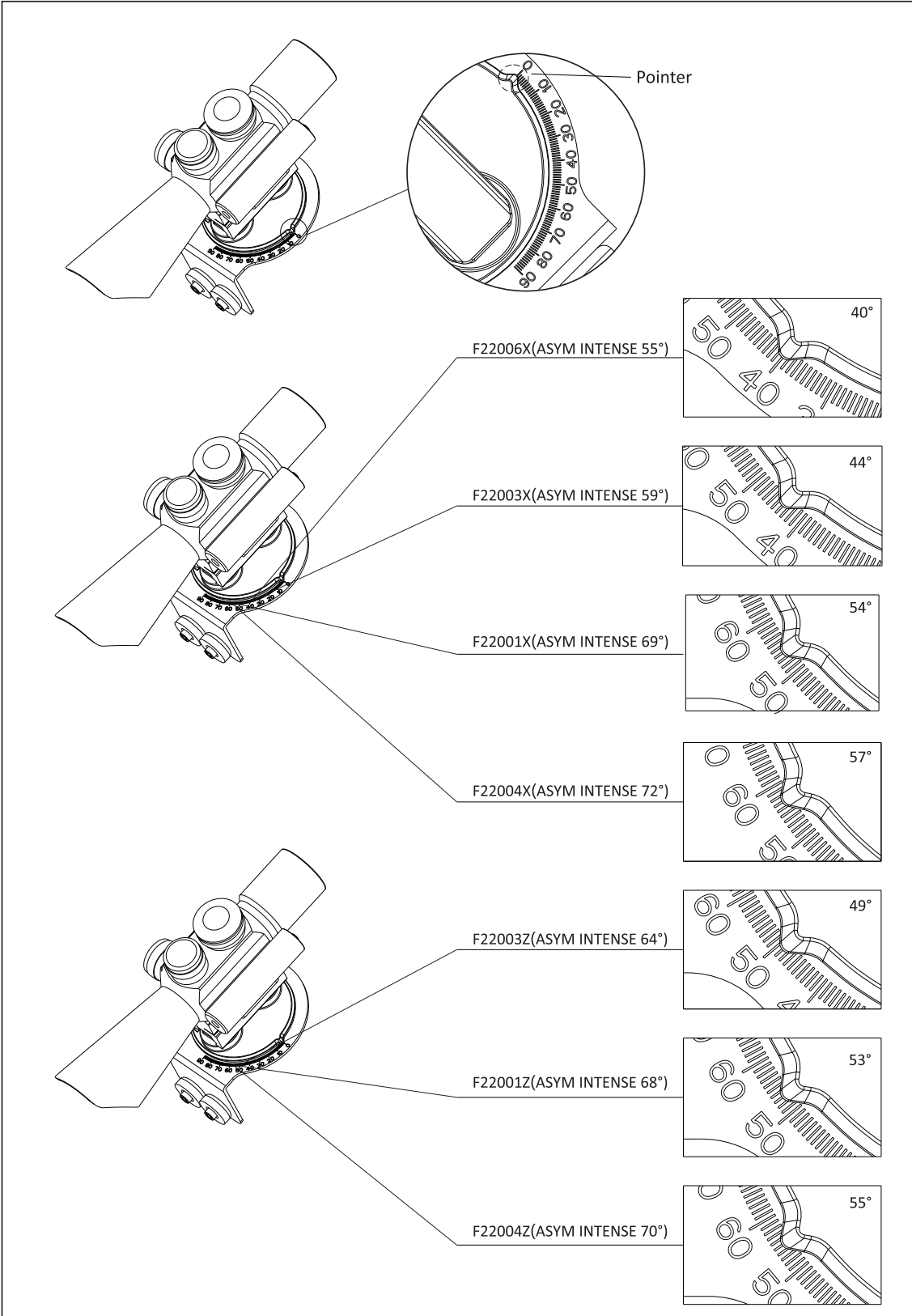

British Electric Lamps Ltd
 BELL House, Foxbridge Way, Normanton Industrial Estate
 Normanton, West Yorkshire. WF6 1TN

T: +44 (0)1924 893380 F: +44 (0)1924 894320
 E: sales@belllighting.co.uk

Date	Revision
04.12.25	2



Installation Instructions: Skyline Powertron Codes: 91827, 91828, 91829, 91830, 11330V2, 11331V2, 11332V2

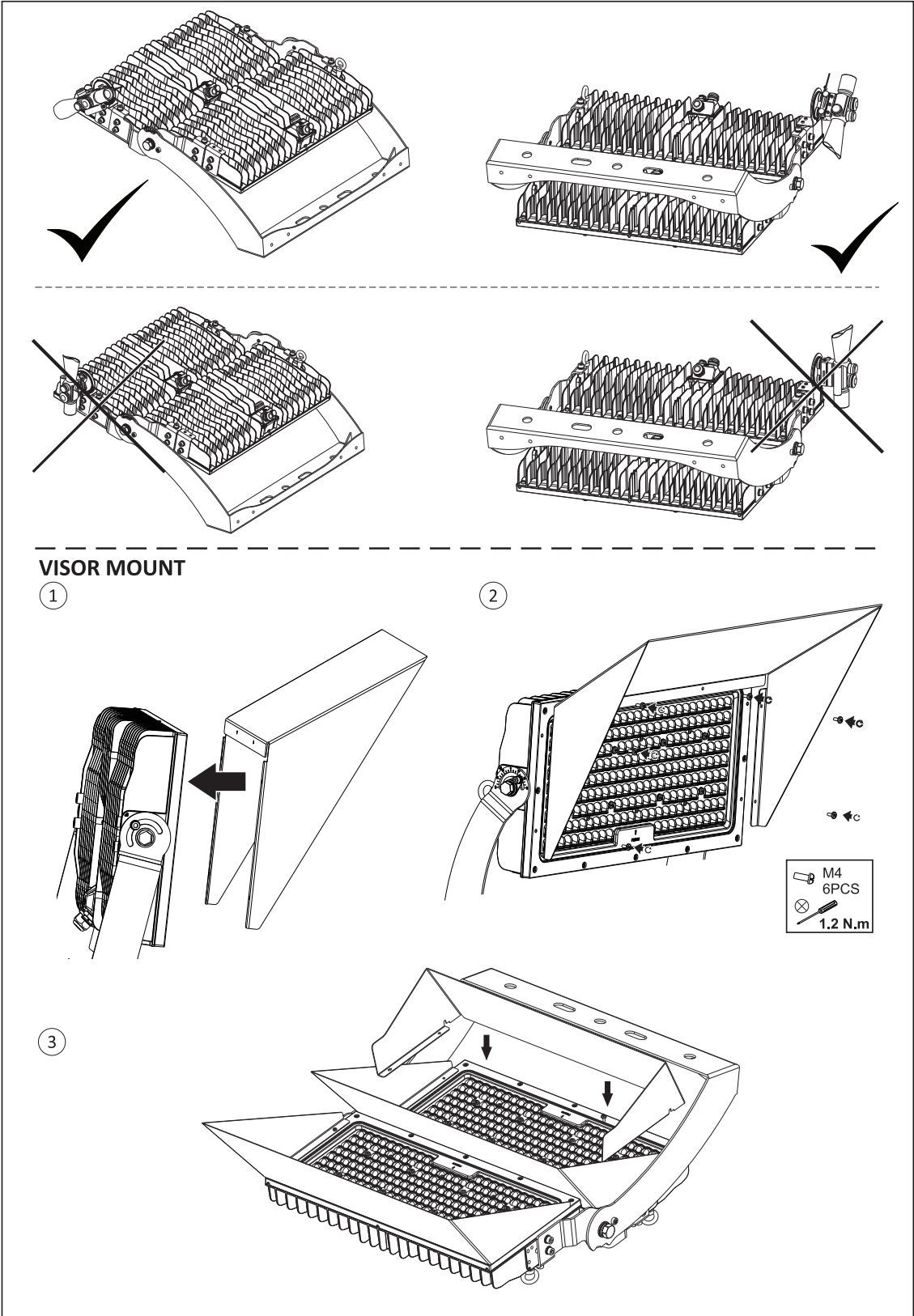

British Electric Lamps Ltd
 BELL House, Foxbridge Way, Normanton Industrial Estate
 Normanton, West Yorkshire. WF6 1TN

T: +44 (0)1924 893380 F: +44 (0)1924 894320
 E: sales@belllighting.co.uk

Helpline +44 (0)1924 893380
www.belllighting.co.uk

www.belllighting.co.uk



Installation Instructions: Skyline Powertron Codes: 91827, 91828, 91829, 91830, 11330V2, 11331V2, 11332V2

4

M4
6PCS
1.2 N.m

5

SAFETY ROPE MOUNT

Safety steel wire rope
Size: $\phi 3\text{mm} \times 3\text{m}$

Rigging keychain
Size: $\phi 8\text{mm} \times 80\text{mm}$

* When installing the safety rope, please ensure the safety rope pass through the holes of the luminaire.

Please note:
It is the installer's responsibility to make sure the safety steel wire rope is fitted to the luminaire.